

# DUNSBOROUGH WASTEWATER

## NOTICE OF PROPOSAL TO CONSTRUCT INFILL SEWERAGE AREAS DUNSBOROUGH 5C AND 9A, PUMPING STATIONS AND PRESSURE MAINS - SHEET 1 OF 2

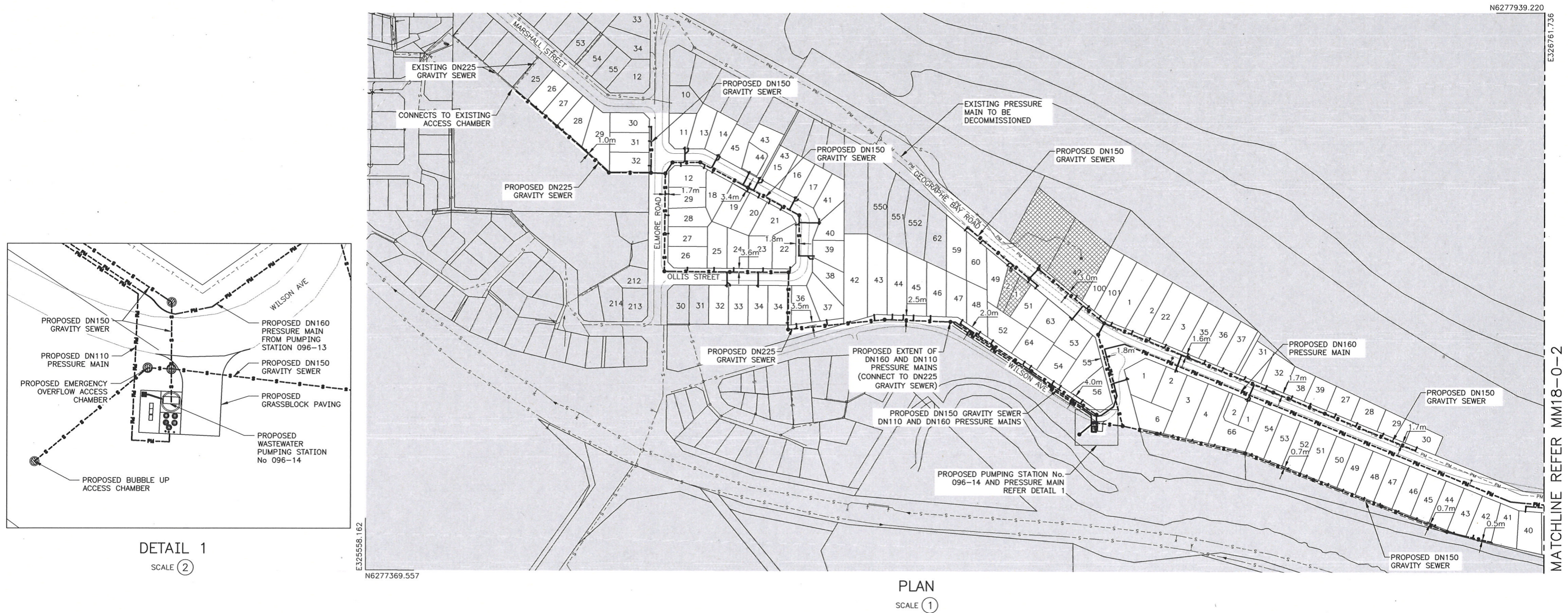

To provide for the disposal of wastewater in Dunsborough the Water Corporation proposes to construct:

- Below ground sewers of up to 225mm diameter and associated Access Chambers
- Two wastewater pumping stations
- Below ground 110mm and 160mm diameter sewer pressure mains

The location of proposed works are shown on the plans.

Further information may be obtained by contacting the Project Manager James Gee on (08) 9420 2961.

Objections to the proposed works will be considered if lodged in writing to the Project Manager at Water Corporation, P.O. Box 100, Leederville 6902, before the close of business 21 calendar days from the date on the attached letter.

### LEGEND

- PROPOSED GRAVITY SEWER MAIN WITH ACCESS CHAMBER AND LOT CONNECTION
- PROPOSED DN90 PRESSURE MAIN
- LOT NUMBERS
- ALIGNMENT OFFSET FROM PROPERTY BOUNDARY
- EXISTING GRAVITY SEWER MAIN WITH ACCESS CHAMBER
- AREA TO BE SEWERED SHOWN NOT SHADED
- SEWERED BY PRIVATE PUMPING SYSTEM
- NOT SEWERED AS PART OF PROPOSAL



DESIGN SURVEY		VERTICAL DATUM AHD	DES CALC R. JONES	NORTH POINT	RECOMMENDED 24/01/17	DUNSBOROUGH WASTEWATER RETICULATION AREAS 5C AND 9A		ORIGINAL SHEET SIZE
ASCON SURVEY		COORDINATE SYS MGA94-50	DES CHD G. WILSENACH		CONSULTANT PROJECT MANAGER	PREREQUISITES TO WORKS		A1
ISSUE	DATE	GRID	DES REF		APPROVED 24/1/17	NOTICE OF PROPOSAL - GENERAL WORKS - SHEET 1 OF 2		
DRN	REC	APPD	DRN G. GRIFFITHS	CONSULTANT PROJECT DIRECTOR	FILE JT1 2016 01487 V01	PLAN	CAD	ISSUE
			Q.C. CHD C. CARNEVALI		PROJECT CS01882	MM18-0-1	A	MF